

## Gasoline & Diesel Driven Solids Handling Pumps

- **Heavy Duty Cast Iron Construction**
- **Buna-N or Viton® Mechanical Seal Options**
- **2" to 3" NPT Port Sizes**
- **Self-Priming up to 20 Ft.**
- **Semi-Open, Clog Resistant Impeller**
- **Engine Options: Honda, Briggs & Stratton Gasoline or Hatz Diesel**
- **Electric Start Options Available**
- **Heavy Duty Steel Roll Frame Included**
- **Optional Wheel Kit Available**
- **Built-in Check Valve**



Model 3168-95  
2" Cast Iron  
Solids Handling  
Pumps



Model 327A-V5  
3" Cast Iron Solids Handling Pump

The AMT line of Engine Driven Solids Handling pumps offers an upgraded debris handling capability in wear resistant cast iron construction. Applications include: high volume liquid transfer, irrigation, commercial draining and construction. All models feature durable all cast iron construction and clog-resistant impeller to ensure a long life for the complete pump. Dual volute design reduces radial load on engines.

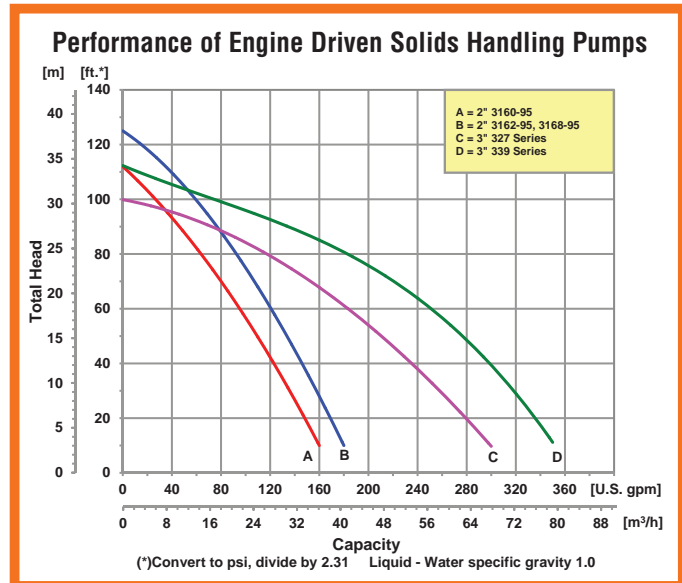

A Gorman-Rupp Company

400 Spring Street • Royersford, PA 19468 USA

[www.amtpump.com](http://www.amtpump.com) • 888-amt-pump (268-7867)

For use with nonflammable liquids compatible with pump component materials. Viton® and Teflon® are registered trademarks of E. I. DuPont.

Tel: 866-777-6060  
Fax: 866-777-6383

Springer Pumps, LLC

Website: [www.springerpumps.com](http://www.springerpumps.com)  
Int'l: +001 267 404 2910

## 2" Solids Handling Pumps

Model	Curve	Port	Driver	Seals	Run Time (Hours)	Tank Size (Gal/Ltr.)	Ship Wt. (Lbs.)
<b>3160-95</b>	A	2" NPT	Briggs & Stratton	Buna-N	1.2	0.52/2.0	75
<b>3162-95</b>	B	2" NPT	B & S Vanguard <sup>▲</sup>	Buna-N	1.3	0.87/3.3	82
<b>3168-95</b>	B	2" NPT	Honda GC160	Buna-N	1.5	0.47/1.7	80

Construction: Cast Iron

Maximum Solids Handling Capacity: 3/8" Diameter

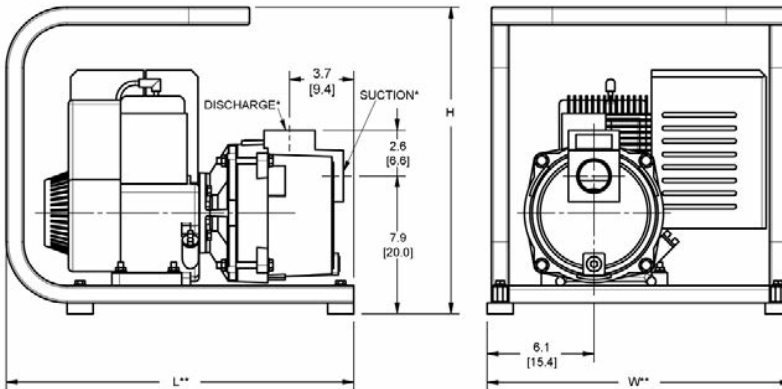

## 3" Solids Handling Pumps

Model	Curve	Port	Driver	Seals	Run Time (Hours)	Tank Size (Gal/Ltr.)	Ship Wt. (Lbs.)
<b>3270-D5</b>	C	3" NPT	Hatz Diesel 1B20	Viton <sup>®</sup>	2.7	0.79/3.0	125
<b>327A-V5</b>	C	3" NPT	Honda GC160	Viton <sup>®</sup>	1.5	0.47/1.7	110
<b>3391-Z5</b>	D	3" NPT	Hatz Diesel 1B30 <sup>**▲</sup>	Viton <sup>®</sup>	2.8	1.32/5.0	195
<b>3390-95</b>	D	3" NPT	B & S Vanguard <sup>▲</sup>	Buna-N	1.3	0.95/3.6	140
<b>3391-V5</b>	D	3" NPT	Honda GX270 <sup>**▲</sup>	Viton <sup>®</sup>	2.5	1.40/5.2	170

Construction: Cast Iron

Maximum Solids Handling Capacity: 3/4" Diameter

(♦) HP Class represents market category and is not intended to define actual horsepower

(\*) Standard NPT pipe thread

(\*\*) This dimension may vary due to engine manufacturer's specifications.

NOTE: Dimensions are in inches (centimeters) and have a tolerance of ± 1/8".

++ 12V DC Electric Start (Battery Not Included)

▲ Oil Alert Included

Model	HP Class ♦	SUC*	DIS*	L**	W**	H
<b>316 Series</b>	4/5 HP	2" FNPT	2" FNPT	20.0 [50.8]	17.5 [44.4]	17.6 [44.7]
<b>327 Series</b>	5 HP	3" FNPT	3" MNPT	24.0 [60.9]	19.2 [48.7]	18.6 [47.2]
<b>339 Series</b>	8 HP	3" FNPT	3" MNPT	31.0 [78.7]	22.5 [57.1]	23.6 [59.9]

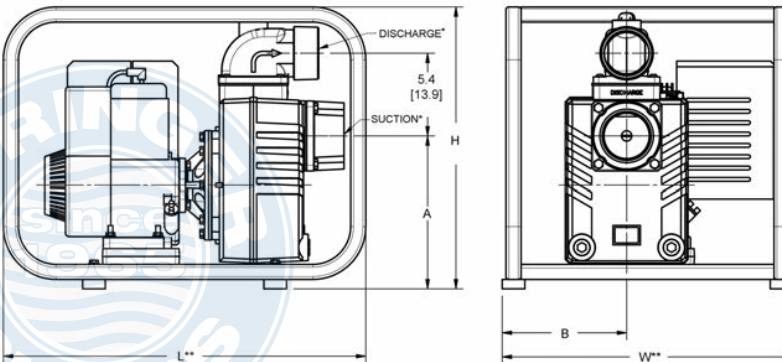

## Optional Wheel Kit For Roll Frame Pumps

Model	Features	Ship Wt. (Lbs.)
<b>C402-90</b>	Includes 10" semi-pneumatic tires on steel wheels with steel clamps and handles for universal mounting to frame.	25